

## REMOVAL

1. DISCONNECT CABLE FROM NEGATIVE BATTERY TERMINAL
2. REMOVE PARKING BRAKE HOLE COVER SUB-ASSEMBLY (See page [IP-11](#))
3. REMOVE SHIFT LEVER KNOB SUB-ASSEMBLY (for Manual Transmission) (See page [IP-11](#))
4. REMOVE SHIFT LEVER KNOB SUB-ASSEMBLY (for 4WD) (See page [IP-11](#))
5. REMOVE CONSOLE UPPER REAR PANEL SUB-ASSEMBLY (See page [IP-12](#))
6. REMOVE BOX BOTTOM MAT (See page [IP-12](#))
7. REMOVE CONSOLE BOX ASSEMBLY REAR (See page [IP-12](#))
8. REMOVE INSTRUMENT LOWER COVER SUB-ASSEMBLY (See page [IP-13](#))
9. REMOVE POWER OUTLET SOCKET
  - (a) Using a screwdriver, disengage the claw, then turn the power outlet socket counterclockwise and push the power outlet socket half way out.

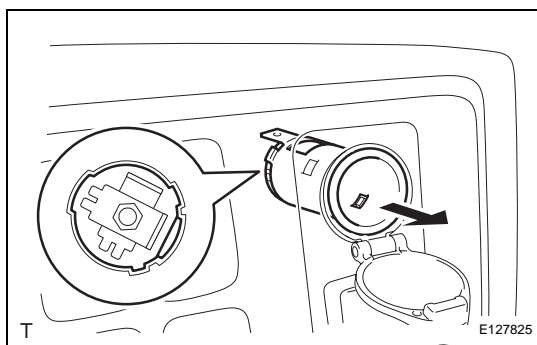

- (b) Align the protrusion of the power outlet socket with the cutout of the power outlet socket cover and then push the power outlet socket out.

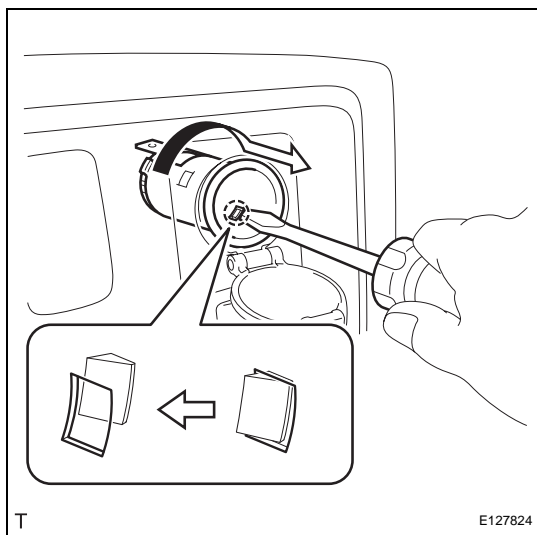
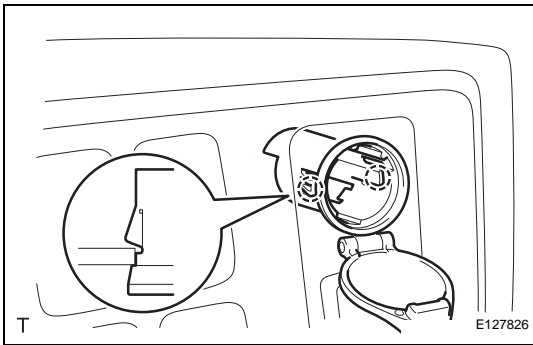

## 10. REMOVE POWER OUTLET SOCKET COVER

- (a) Disengage the 2 claws and remove the power outlet socket cover.

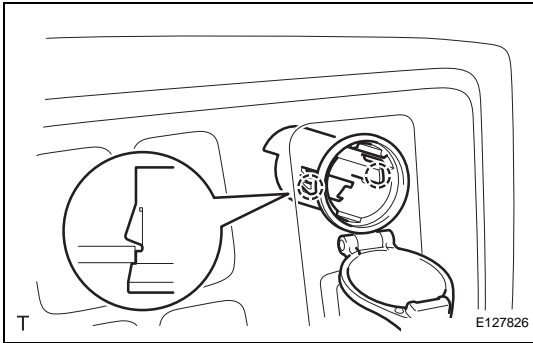

## INSTALLATION

### 1. INSTALL POWER OUTLET SOCKET COVER

- (a) Engage the 2 claws and install a new power outlet socket cover.

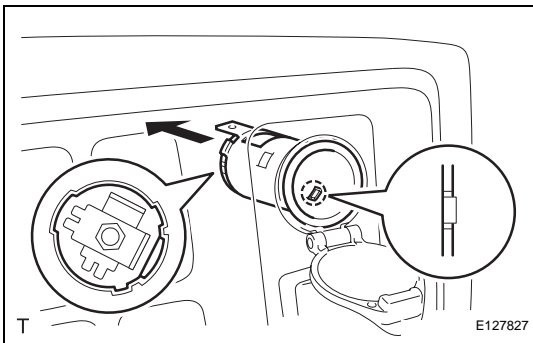

### 2. INSTALL POWER OUTLET SOCKET

- (a) Align the protrusion of the power outlet socket with the cutout of the power outlet socket cover and install the power outlet socket.
- (b) Securely engage the claw.

### 3. INSTALL INSTRUMENT LOWER COVER SUB-ASSEMBLY (See page [IP-30](#))

### 4. INSTALL CONSOLE BOX ASSEMBLY REAR (See page [IP-31](#))

### 5. INSTALL BOX BOTTOM MAT (See page [IP-31](#))

### 6. INSTALL CONSOLE UPPER REAR PANEL SUB-ASSEMBLY (See page [IP-31](#))

### 7. INSTALL SHIFT LEVER KNOB SUB-ASSEMBLY (for 4WD) (See page [IP-32](#))

### 8. INSTALL SHIFT LEVER KNOB SUB-ASSEMBLY (for Manual Transmission) (See page [IP-32](#))

### 9. INSTALL PARKING BRAKE HOLE COVER SUB-ASSEMBLY (See page [IP-32](#))

### 10. CONNECT CABLE TO NEGATIVE BATTERY TERMINAL

Torque: 3.9 N\*m (40 kgf\*cm, 35 in.\*lbf)